

Single continuous wire in masonry veneer walls was a code requirement for seismic zones

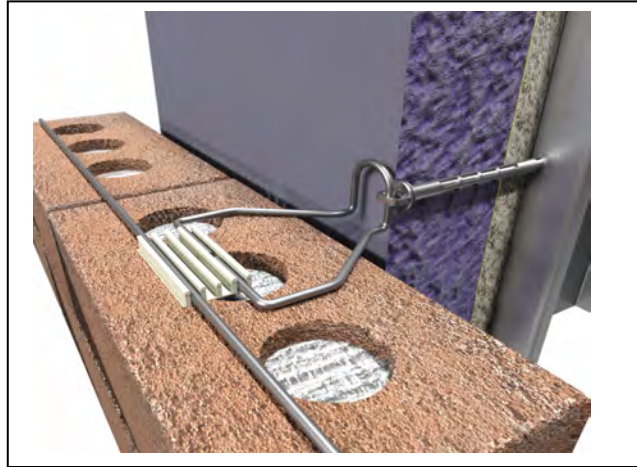
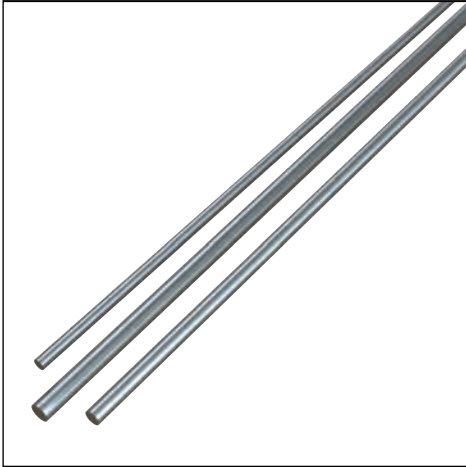

Continuous Wire is available in 9 gage or 3/16" wire in 10 ft lengths.

Available in Mill Galvanized, Hotdip Galvanized or Type 304 Stainless Steel.

The 1995 through 2011 editions of the Masonry Building Code required that Seismic Design Categories E and F include a single continuous wire in the veneer that was mechanically tied back to the backup with clips or hooks. Shake Table research in 2010 has shown that this requirement is not necessary or useful so the requirement has been removed with the 2013 TMS 402 Building Code which was incorporated into the 2015 IBC edition. Municipalities under earlier versions of the 2015 IBC still may be required to utilize this seismic system. See product #370 Seismic Clip for the anchor portion.

See #363 Plastic Seismic Clip for attachment of Continuous wire to the wire veneer anchor.

Material Specifications

Stainless Steel: Sheet metal anchors and ties: ASTM A 167, ASTM A 666, ASTM A 240/A240M AISI Type 304.

(AISI Type 316 available upon request)

Hotdip Galvanized: ASTM A 153 Class B-2: (1.50 oz/ ft².) (0.46kg/m²)

Plain Carbon Steel: ASTM A1008/A1008M Structural Steel ASTM A36/A36M-08