

**Submittal Sheet**  
**#341-A L-Anchor with Two Holes**

**Custom Made:**

Used for attaching masonry to various backups.  
 Specify length, width, bend length, steel type and hole configurations.

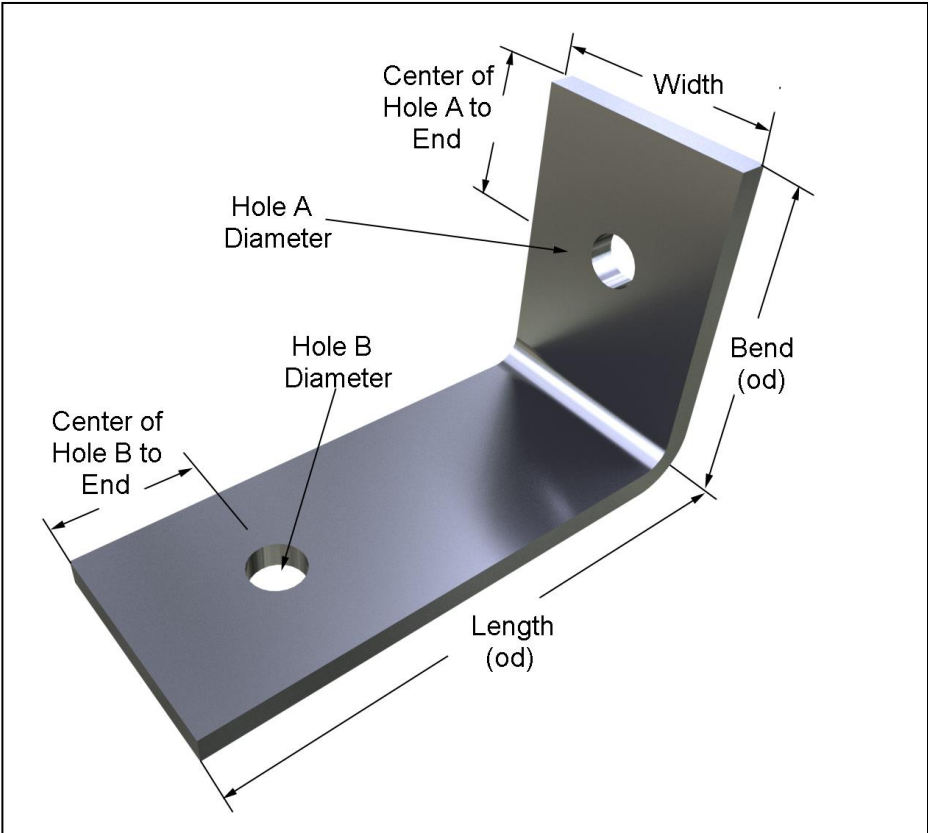

**Made to Order:**

Thickness:  3/8"     1/4"     3/16"     1/8"  
 12 gage     14 gage     16 gage

Length od: \_\_\_\_\_      Width: \_\_\_\_\_

Bend (od): \_\_\_\_\_

Hole A Diameter: \_\_\_\_\_      Hole B Diameter: \_\_\_\_\_

Center of Hole A to End: \_\_\_\_\_

Center of Hole B to End: \_\_\_\_\_

Finish:  Stainless type 304     Hot Dip Galvanized  
 Mill Galvanized     Zinc Alloy 710

Quantity: \_\_\_\_\_

**Material Specifications**

**Stainless Steel:** Sheet metal anchors and ties: ASTM A 167, ASTM A 666, ASTM A 240/A240M AISI Type 304.  
 Wire ties and anchors: ASTM A 580 AISI Type 304 (AISI Type 316 available upon request)

**Hotdip Galvanized:** ASTM A 153 Class B-2: (1.50 oz/ ft<sup>2</sup>).(0.46kg/m<sup>2</sup>)

**Mill Galvanized:** Sheet metal anchors and ties: ASTM A 653 G60  
 Wire: ASTM A 641 (0.1 oz/ ft<sup>2</sup>.)

**Plain Carbon Steel:** ASTM A1008/A1008M Structural Steel ASTM A36/A36M-08  
 Wire: ASTM A 82/A82M Tensile Strengths 80,000 psi Yield Point 70,000 psi

**Firewall Anchors:** Rolled Strip Zinc Alloy 710. (Firewall alloy 1/8" and 16 gage only)