

Submittal Sheet
#154-A Double Half-Pin Stone Anchor

Specify Location of Pin from center of pin to end. 1/2" minimum of steel between end of anchor and start of hole is recommended.

Pins are welded in place.

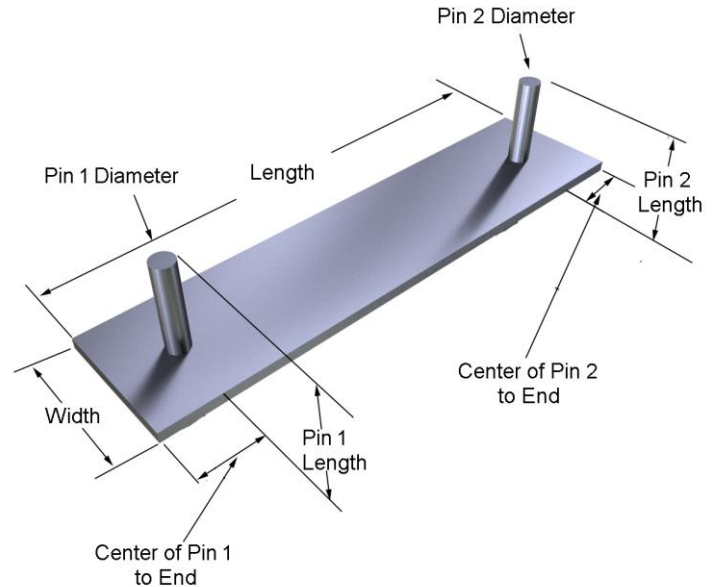

Made to Order

Anchor

Thickness: 3/8" 1/4" 3/16" 1/8"
 12 gage 14 gage 16 gage

Width: _____ Length: _____

Pin 1 - Hole Location: Centered _____ from end

Pin 2 - Hole Location: Centered _____ from end

Finish: Stainless type 304 Hot Dip Galvanized
 Mill Galvanized Plain Steel

Pin

Pin 1 Diameter: 1/4" 3/8" 1/2" 5/8" 3/4"

Pin 1 Length: _____

Pin 2 Diameter: 1/4" 3/8" 1/2" 5/8" 3/4"

Pin 2 Length: _____ Quantity: _____

Material Specifications

Stainless Steel: Sheet metal anchors and ties: ASTM A 167, ASTM A 666, ASTM A 240/A240M AISI Type 304.

Wire ties and anchors: ASTM A 580 AISI Type 304
(AISI Type 316 available upon request)

Hotdip Galvanized: ASTM A 153 Class B-2: (1.50 oz/ ft²).(0.46kg/m²)

Mill Galvanized: Sheet metal anchors and ties: ASTM A 653 G60
Wire: ASTM A 641 (0.1 oz/ ft².)

Plain Carbon Steel: ASTM A1008/A1008M Structural Steel ASTM A36/A36M-08
Wire: ASTM A 82/A82M Tensile Strengths 80,000 psi Yield Point 70,000 psi