

Used to attach brick veneer or stone to an existing backup wall (wood, concrete, brick, or block). The #132 Channel Slots are attached to the backup and Channel Slot anchors are inserted into the #132.

See #130 and #133 for Additional Slot Types.

See #129, #122, #123, #124, #125, and #134 for Channel Slot Brick Veneer Anchors

See #127, #135, #136, #137, #138, and #139 for Channel Slot Stone Anchors.

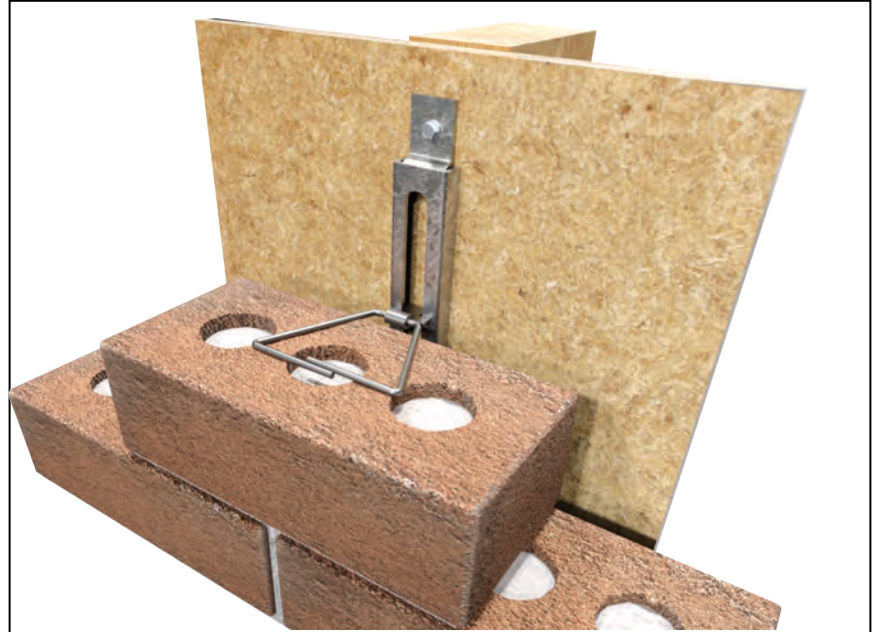
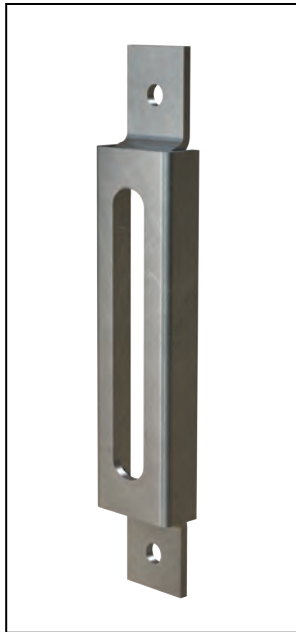

**Standards - 1 size only:**

Thickness: 12 gauge

Finish: Type 304 Stainless Steel

Overall Length: 6"                      Width" 1-5/8"

Slot is 19/32" x 3" long              Holes are 9/32"

Anchor extends 5/8" out from backup wall

Quantity: \_\_\_\_\_

**Material Specifications**

**Stainless Steel:** Sheet metal anchors and ties:  
 ASTM A 167, ASTM A 666, ASTM A  
 240/A240M AISI Type 304.  
 (AISI Type 316 available upon request)