

Submittal Sheet
#106 Dovetail Corrugated Anchor

Used for attaching brick veneer to an existing concrete wall with #100 Dovetail Anchor Slots poured In place.

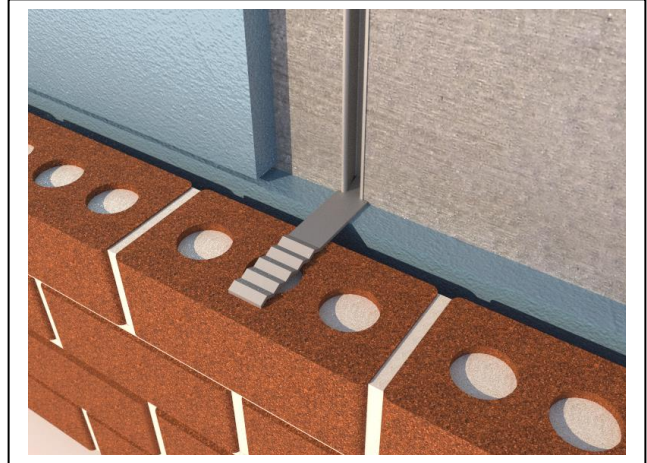
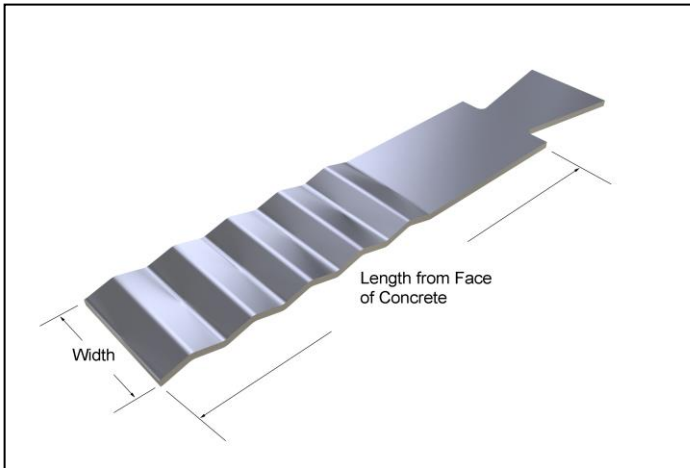

Standards: 1" wide

Thickness: 12 gage 16 gage
 Length from face of concrete: 3 1/2" 5 1/2" 7 1/2"
 Finish: Stainless type 304 Hot Dip Galvanized
 Mill Galvanized

Specials:

Thickness: 3/16" 1/8" 12 gage
 14 gage 16 gage
 Length from face of concrete: _____
 Width: (minimum 1") _____
 Finish: Stainless type 304 Hot Dip Galvanized
 Mill Galvanized Zinc Alloy 710
 Quantity: _____

Material Specifications

Stainless Steel: Sheet metal anchors and ties: ASTM A 167, ASTM A 666, ASTM A 240/A240M AISI Type 304.
 (AISI Type 316 available upon request)

Hotdip Galvanized: ASTM A 153 Class B-2:
 (1.50 oz/ ft².) (0.46kg/m²)

Mill Galvanized: Sheet metal anchors and ties: ASTM A 653 G60

Plain Carbon Steel: ASTM A1008/A1008M
 Structural Steel ASTM A36/A36M-08