



Heckmann Building Products Inc.

1501 N. 31st Avenue

Melrose Park, IL 60160-2911

800-621-4140 or 708-865-2403 Fax: 708-865-2640

www.heckmannbuildingprods.com

SUBMITTAL SHEET: #444 THREADED INSERTS

SIZE: See chart below for bolt sizes

APPLICATION: Threaded inserts are cast in concrete and offer a clean and unobtrusive appearance without protrusion beyond the face of the concrete. They permit anchor bolts and eye bolts to be removed and reinstalled as often as required.

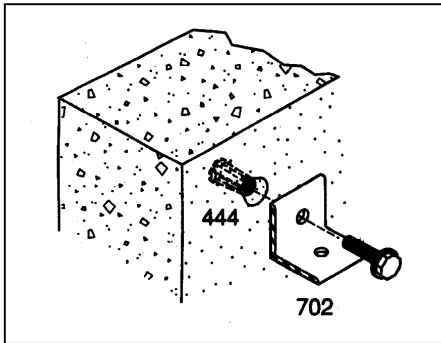

TEST CONDITIONS: The following chart is based on the average of many physical tests under proper conditions. (To obtain maximum load of insert machine bolt thread engagement must be at least 75% of the depth of the threaded hole. Use either bolts or threaded rods when attaching fixtures to the inserts.)

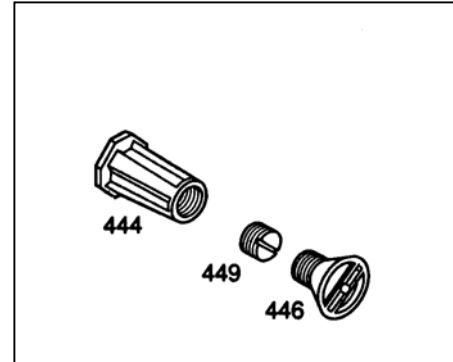

Stainless Steel:

Sheet metal anchors and ties: ASTM A 167 AISI Type 304.

Plate and bent bar anchors: ASTM A 666 AISI Type 304.

Wire ties and anchors: ASTM A 580 AISI Type 304.

Hotdip Galvanized:

ASTM A 153 Class B-2: (1.50 oz/ ft²)(0.46kg/m²)

Mill Galvanized:

Sheet metal anchors and ties: ASTM A 653 G60

Wire: ASTM A 641 (0.1 oz/ ft²)

Plain Steel:

Sheet Metal anchors and ties: ASTM A 569, ASTM A 366.

Plates, bars, and shapes: ASTM A 123, ASTM A 36.

Wire: ASTM A 82, ASTM A 82-95a.

Approvals:

Comments:

Standard Number	Size	Bolt Size	Ultimate Load In Tension
P-15-T	1/4" x 1-1/2"	1/4-20	2,950
P-24-T	3/8" x 1"	3/8-16	5,712
P-25-T	3/8" x 1 3/8"	3/8-16	6,797
P-35-T	1/2" x 1 1/2"	1/2-13	8,945
P-36-T	1/2" x 2 7/8"	1/2-13	15,482
P-45-T	5/8" x 1 11/16"	5/8-11	11,800
P-46-T	5/8" x 2 7/8"	5/8-11	16,969
P-55-T	3/4" x 1 11/16"	3/4-10	6,207

The strength of the concrete used in this test was over 5,000 psi.