

HECKMANN BUILDING PRODUCTS INC.
1501 N. 31st AVENUE
MELROSE PARK, IL 60160-2911
800-621-4140 AND 708-865-2403
FAX: 708-865-2640
www.heckmannbuildingprods.com

**WELDED STRUCTURAL STEEL
 ANCHORS
 FOR ATTACHING MASONRY TO
 STRUCTURAL STEEL**

No. 315 Weld-On Anchor Rods: 1/4" dia. (6.35 mm) x 9" (229 mm) long or 5" (127 mm) long. Specify Stainless, Hotdip Galvanized After Fabrication, Mill Galvanized, or Plain Steel. See Page 8 for Adjustable Wire Ties.



315

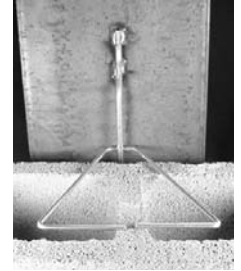
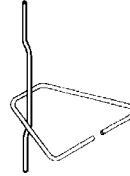

No. 315-B Weld-On Anchor Straps: 12 gage x 3/4" (19.05 mm) wide x 9" (229 mm) long or 7/8" (22.2 mm) wide x 6-1/2" (165 mm) long. Specify Stainless, Hotdip Galvanized After Fabrication, Mill Galvanized, or Plain Steel. See Page 8 for Adjustable Wire Ties.



315-B



Ties for Masonry:

No. 316 Triangle Ties: 3/16" dia. (4.76 mm) wire. Also available in 1/4" dia. (6.35 mm). Closed end is 1" (25.4 mm) wide. Standard Lengths are 3" (76 mm), 4" (102 mm), 5" (127 mm), 7" (178 mm), 9" (229 mm), and 11" (279 mm). Specify Stainless, Hotdip Galvanized, or Mill Galvanized. Custom sizes available.



316

Ties for Masonry:

No. 318 Web Ties: 3/16" dia. (4.76 mm) wire 12" (305 mm) long. Available for nominal wall thicknesses of 4" (102 mm), 6" (152 mm), 8" (203 mm), 10" (254 mm), and 12" (305 mm). Specify Stainless, Hotdip Galvanized, or Mill Galvanized.

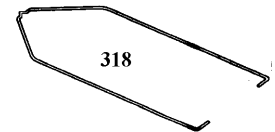

318

No. 317 Continuous Weld-On Anchor Rods: 1/4" dia. (6.35 mm) x 8 ft (2.44 m) with six 3/8" (9.53 mm) offsets, each providing 7-3/4" (197 mm) vertical adjustment and are spaced 16-1/4" (413 mm) o.c.

No. 317-B Continuous Weld-On Anchor Straps: 12 gage x 3/4" (19.05 mm) wide. Same configuration as No. 317.



317



317-B



HECKMANN BUILDING PRODUCTS INC.
1501 N. 31ST AVENUE
MELROSE PARK, IL 60160-2911
800-621-4140 AND 708-865-2403
FAX: 708-865-2640
www.heckmannbuildingprods.com

**WELDED STRUCTURAL STEEL
 ANCHORS
 FOR ATTACHING MASONRY TO
 STRUCTURAL STEEL**

No. 308 Receptical Slot Anchor. 14 gage or 1/8" (3.17mm) x 7" (178 mm) high with 1" (25.4 mm) bend for welding to beam. 5" slot for wire tie. Specify length from beam to end of anchor. Specify Plain Steel or Hotdip Galvanized After Fabrication. See Page 8 for Adjustable Wire Ties.

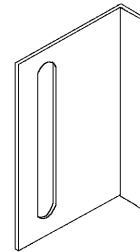

No. 133 Long-Type Channel Slot: Build into new masonry walls using channel slot anchors set into backup wall or attach to an existing concrete or masonry wall using expansion anchors and bridge plate. Slots are 7-3/8" (187 mm) long with 3/4" (19 mm) between each slot. 16 gage channel slots are available in 5 ft. (1.524 m) lengths (7 slots) or 10 ft. (3.048 m) lengths (14 slots). Typical spacing is 16" (406 mm) o.c. Available in Stainless, Hotdip Galvanized After Fabrication, or Plain Steel.

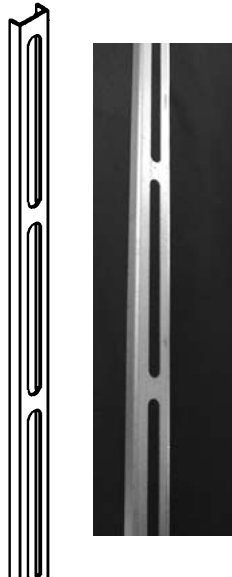

No. 130 Weld-On Channel Slot: Weld to steel columns and beams in the shop or field. 8" (203.2 mm) long x 1-3/8" (35mm) wide with a 9/16" (14 mm) x 5-1/2" (140 mm) slot. Available in 16 gage or 11 gage in Stainless, Hotdip Galvanized After Fabrication, Mill Galvanized, or Plain Steel. (Primer touchup may be required at the welds.)



No. 320 Weld-On Clip: 1" (25.4 mm) high x 1-1/4" (32 mm) wide x 14 gage with 3/16" (4.76 mm) offset for anchor, Specify Plain Steel or Hotdip Galvanized After Fabrication.

No. 321 Corrugated L-Tie: 3" (76 mm), 5" (127 mm), 7" (178 mm), or 9" (229 mm) lengths x 3/4" (19 mm) wide x 14 gage. Adjustment bend is 4" (102 mm) long. Mill Galvanized or Hotdip Galvanized After Fabrication.

No. 322 U-Type Tie: Made to order. Cannot be thicker than 14 gage or wider than 3/4" (19 mm). Mill Galvanized or Hotdip Galvanized After Fabrication.

